

**MCX REVERSE POLARITY**  
RF COAXIAL CONNECTORS



**Key performance**

- Characteristic Impedance : 50 Ω
- Frequency range : 0~6 GHz
- Contact resistance :
  - Center conductor ≤ 4.0m Ω
  - Out conductor ≤ 2.0m Ω
- Insulation resistance : ≥ 1000M Ω
- Insulator voltage withstanding : 750V
- VSWR : ≤ 1.30
- Connector durability : 500 cycles
- Applicable spec/std: IEC1169-36

**Material**

- Center contacts:
  - Male---brass, gold plated.
  - Female---beryllium copper, gold plated
- Bodies and other metal parts:
  - brass, gold plated
- Insulators: TFE
- Crimp ferrule: copper, nickel plated.
- Gasket and seal rings: silicone rubber
- Heat-shrink tubing: thermofit plastic.

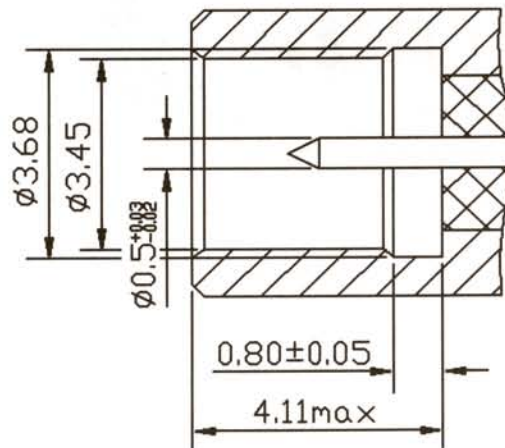
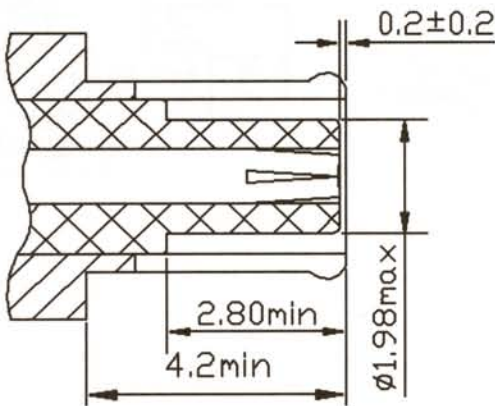

MCX-FKB2

Cable Code: B2

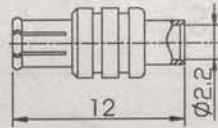

MCX-FK2

Cable Code: 2

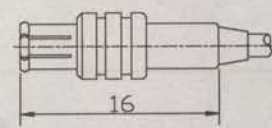

MCX-FK3

Cable Code: 3

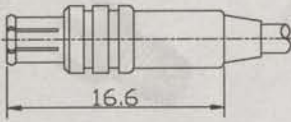

MCX-FKW2

Cable Code: 2

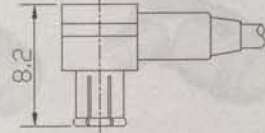

MCX-FKHD

Cable Code: B2

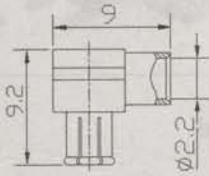
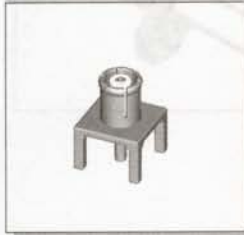

MCX-FKW3

Cable Code: 3

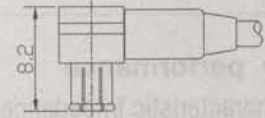

MCX-FJ2

Cable Code: 2

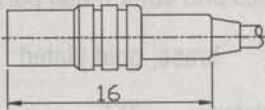

MCX-FJ3

Cable Code: 3

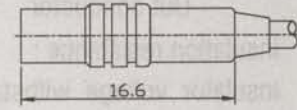

MCX-FJY

mounting hole

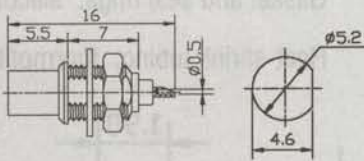

MCX-FJF

mounting hole

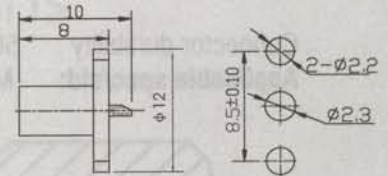

MCX-FJHD

mounting hole

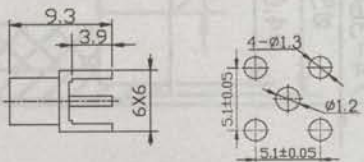
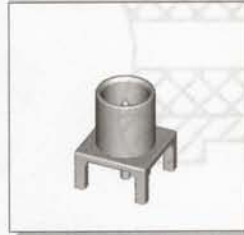

MCX-FJWHD

mounting hole

