

SERIES SSMB-75  
RF COAXIAL CONNECTORS



**Key performance**

- Characteristic Impedance : 75 Ω
- Frequency range : 0~2GHz
- Contact resistance :
  - Center conductor ≤6.0m Ω
  - Out conductor ≤1.0m Ω
- Insulation resistance : ≥1000M Ω
- Insulator voltage withstanding : 750V
- VSWR : ≤1.30
- Connector durability : 500 cycles

**Applicable spec/std : MIL-C-39012**

**Material**

- Center contacts:
  - Male---brass, gold plated.
  - Female---beryllium copper, gold plated
- Bodies other metal parts:
  - brass, gold plated
- Insulators: TFE
- Crimp ferrule: copper, nickel plated.
- Gasket and seal rings: silicone rubber
- Heat-shrink tubing: thermofit plastic.

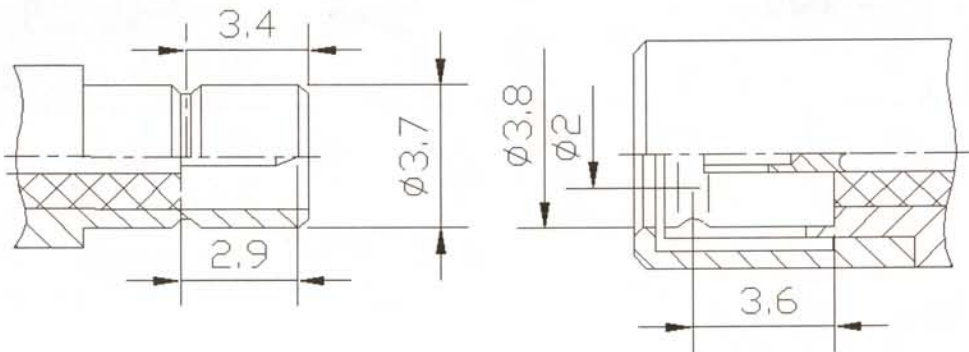

SSMB-75J2 ...



Type	Cable code
SSMB-75J2	2
SSMB-75J3	3

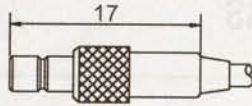

SSMB-75JW2 ...



Type	Cable code
SSMB-75JW2	2
SSMB-75JW3	3

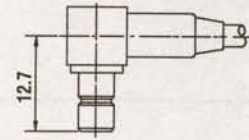

SSMB-75JY2 ...



Type	Cable code
SSMB-75JY2	2
SSMB-75JY3	3

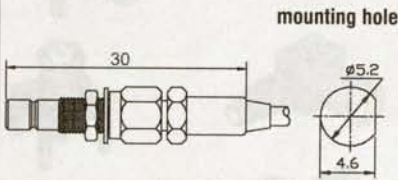

SSMB-75JF2 ...



Type	Cable code
SSMB-75JF2	2
SSMB-75JF3	3

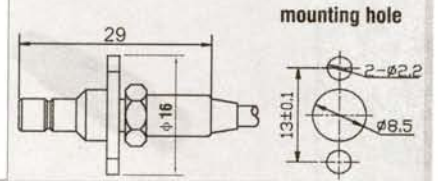

SSMB-75K2 ...



Type	Cable code
SSMB-75K2	2
SSMB-75K3	3

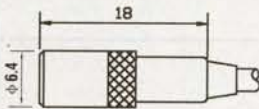

SSMB-75KW2 ...



Type	Cable code
SSMB-75KW2	2
SSMB-75KW3	3

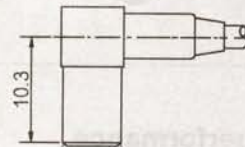

SSMB-75KY2 ...



Type	Cable code
SSMB-75KY2	2
SSMB-75KY3	3

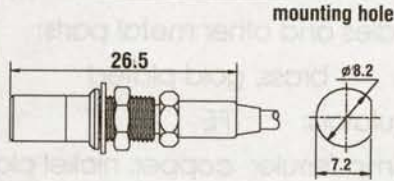

SSMB-75JFD

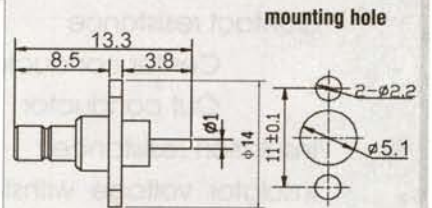

SSMB-75JYD

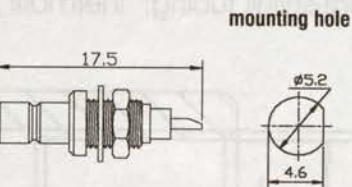

SSMB-75JHD

