

## SERIES SSMA

### RF COAXIAL CONNECTORS

Series SSMA was the first to selected for use in millimeter applications. While the structure is similar to SMA connectors the size is smaller. The SSMA connector is recommended for use to 40GHz.



#### Key performance

Characteristic Impedance : 50 Ω

Frequency range : 0~40GHz

Contact resistance :

Center conductor ≤5.0m Ω

Out conductor ≤2.0m Ω

Insulation resistance : ≥1000M Ω

Insulator voltage withstanding : 750V

VSWR : ≤1.07+0.010f(GHz)

Connector durability : 500 cycles

**Applicable spec/std** : MIL-C-39012

#### Material

Center contacts:

Male---brass, gold plated.

Female---beryllium copper, gold plated

Bodies and other metal parts:

brass, nickel plated

Insulators: TFE

Crimp ferrule: copper, nickel plated.

Gasket and seal rings: silicone rubber

Heat-shrink tubing: thermofit plastic.

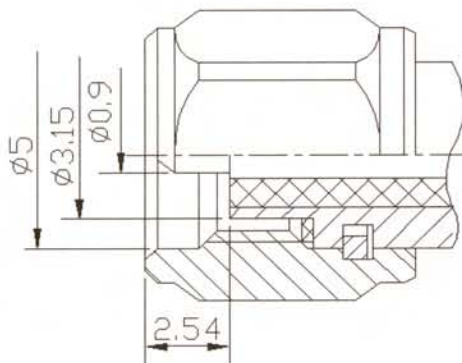
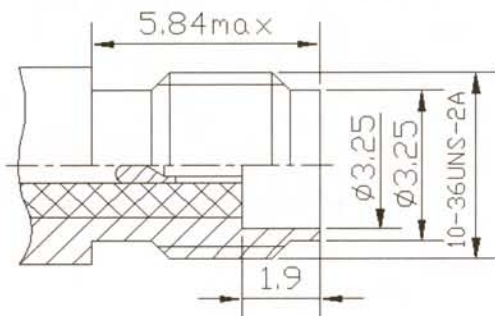

SSMA-JB2

Cable code B2

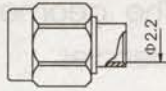

SSMA-J2, J3

| Type    | Cable code |
|---------|------------|
| SSMA-J2 | 2          |
| SSMA-J3 | 3          |

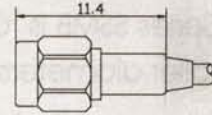

SSMA-JWB2

Cable code B2

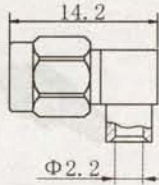

SSMA-JW2, JW3

| Type     | Cable code |
|----------|------------|
| SSMA-JW2 | 2          |
| SSMA-JW3 | 3          |

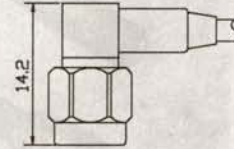

SSMA-KFB2

Cable code B2

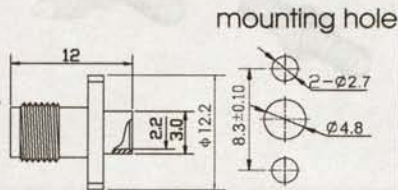

SSMA-KYD

mounting hole

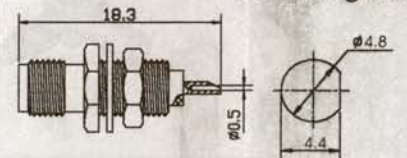

SSMA-JFD

mounting hole

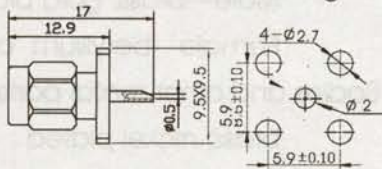

SSMA-KFD

mounting hole

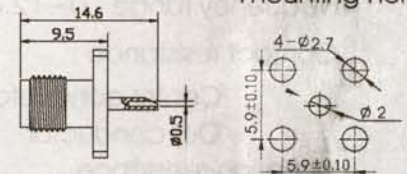

SSMA-KFD4

mounting hole

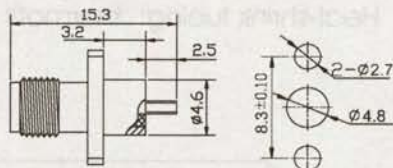

SSMA-KFD1...

mounting hole

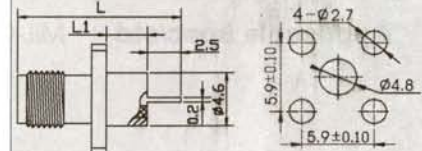

SSMA-KK

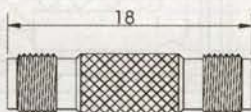

| Type      | L    | L1  |
|-----------|------|-----|
| SSMA-KFD1 | 14.3 | 2.4 |
| SSMA-KFD2 | 15.3 | 3.2 |
| SSMA-KFD3 | 16.9 | 4.8 |