

## SERIES SSMB

### RF COAXIAL CONNECTORS

Series SSMB is a smaller version of type SMB. The geometry is identical but the smaller diameters allow them to run at higher frequencies.



#### Key performance

- Characteristic Impedance : 50  $\Omega$
- Frequency range : 0~12.4GHz
- Contact resistance :
  - Center conductor  $\leq 5.0m\ \Omega$
  - Out conductor  $\leq 2.5m\ \Omega$
- Insulation resistance :  $\geq 1000M\ \Omega$
- Insulator voltage withstanding : 500V
- VSWR :  $\leq 1.35$
- Connector durability : 500 cycles

**Applicable spec/std** : MIL-C-39012

#### Material

- Center contacts:
  - Male---brass, gold plated.
  - Female---beryllium copper, gold plated
- Bodies and other metal parts:
  - brass, nickel plated
- Insulators: TFE
- Crimp ferrule: copper, nickel plated.
- Gasket and seal rings: silicone rubber
- Heat-shrink tubing: thermofit plastic.

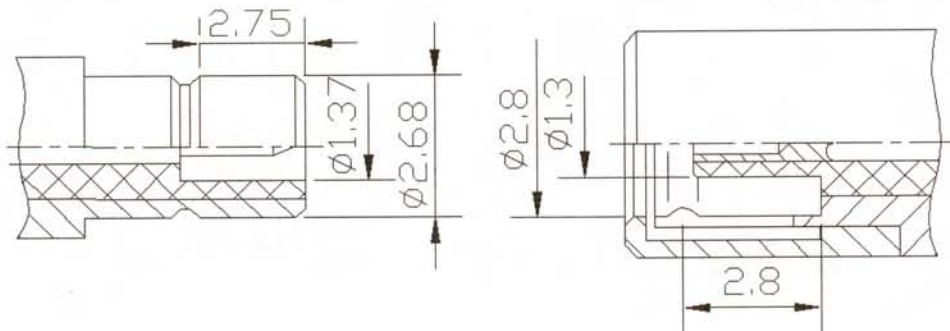

SSMB-K2

Cable code B2

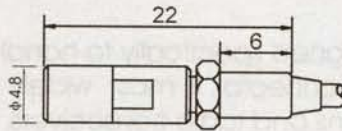

SSMB-KW2

Cable code B2

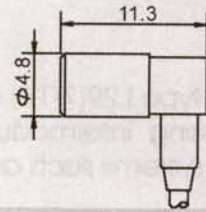

SSMB-JF2

Cable code B2 mounting hole

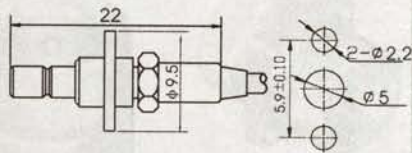

SSMB-JW2

Cable code B2

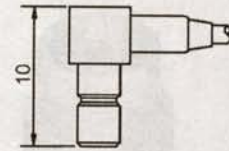

SSMB-JY2

Cable code B2 mounting hole

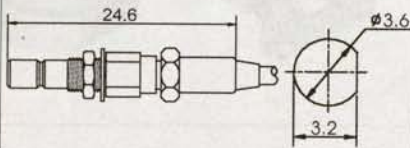

SSMB-JWY

mounting hole

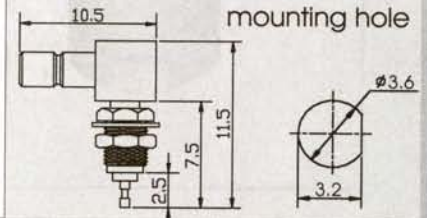

SSMB-JHD

mounting hole

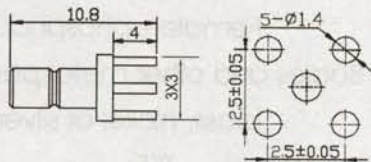

SSMB-JWHD

mounting hole

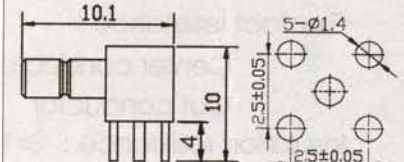

SSMB-JY

mounting hole

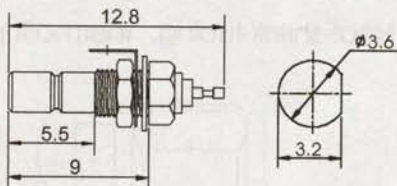

SSMB-JYA

mounting hole

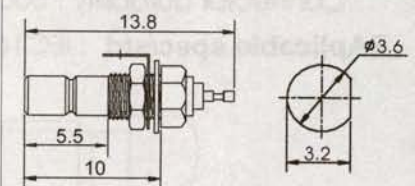

SSMB-JY-1

mounting hole

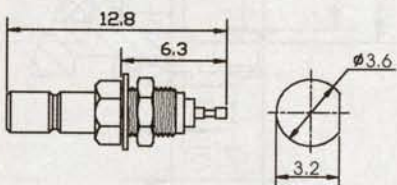

SSMB-JJ

mounting hole

