

SERIES SSMB RF COAXIAL CONNECTORS

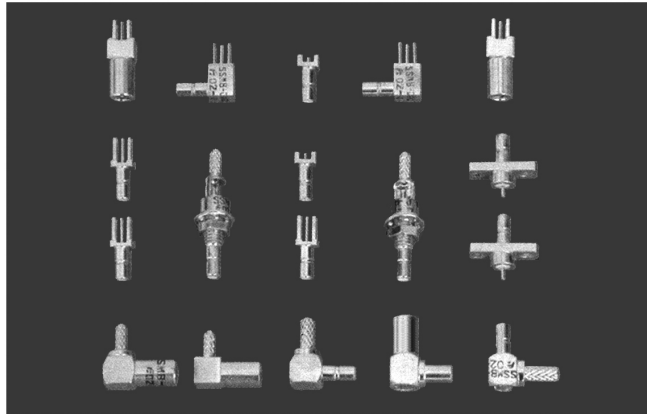

Key performance

Characteristic Impedance : 50 Ω

Frequency range : 0~3GHz

Contact resistance :

Center conductor ≤ 5.0m Ω

Out conductor ≤ 2.50m Ω

Insulation resistance : ≥ 1000M Ω

Insulator voltage withstanding : 500V

VSWR:

Straight connector: ≤ 1.22 (0~1GHz) ; ≤ 1.35 (0~3GHz)

Right angle connector: ≤ 1.50 (0~1GHz) ; ≤ 1.63 (0~3GHz)

Connector durability : 500 cycles

Applicable spec/std : MIL-C-39012

Material

Center contacts:

Male---brass, gold plated.

Female---beryllium copper, gold plated

Bodies and other metal parts:

brass, gold plated

Insulators: Teflon

Crimp ferrule: copper, nickel plated.

Gasket and seal rings: silicone rubber

Heat-shrink tubing: thermofit plastic.

Interface Dimensions

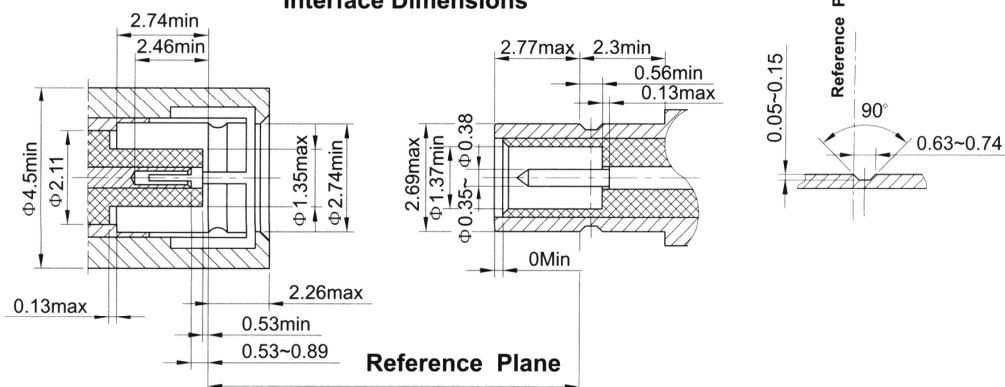

SSMB SERIES

CERNEX, Inc.

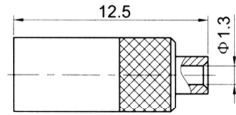
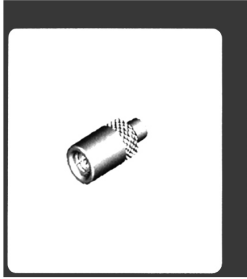

Type	part number	suitable cable	Note
SSMB-KB1	1020-6600	B1	

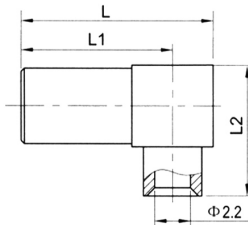
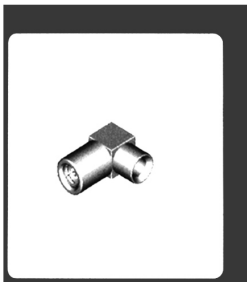

Type	part number	suitable cable	L	L1	L2	Note
SSMB-KWB2	1040-6600	B2	11.8	9.3	8	Match outer contact
SSMB-KWB2A	1040-6601	B2	12.3	9.55	10.5	

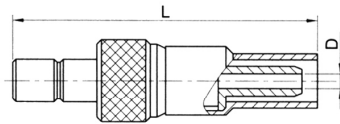
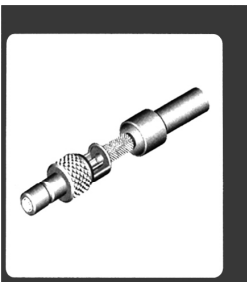

Type	part number	suitable cable	L	D	Note
SSMB-J2	1010-6500	2	21	Φ0.9	
SSMB-J3	1010-6501	3	24	Φ1.6	

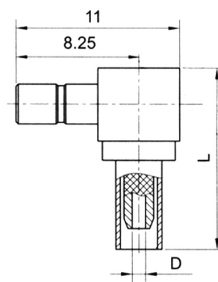
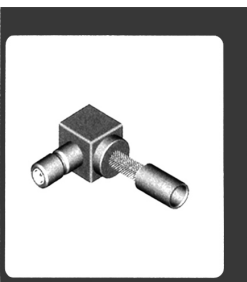

Type	part number	suitable cable	L	D	Note
SSMB-JW2	1030-6500	2	12.3	Φ0.9	
SSMB-JW3	1030-6501	3	12.9	Φ1.6	

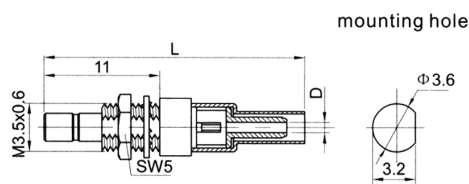
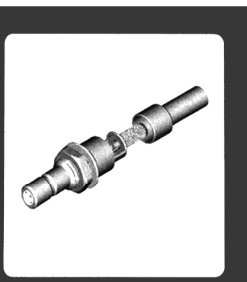

Type	part number	suitable cable	L	D	Note
SSMB-JY2	1010-2500	2	24.4	Φ0.9	
SSMB-JY3	1010-2501	3	28	Φ1.6	

SSMB SERIES

CERNEX, Inc.

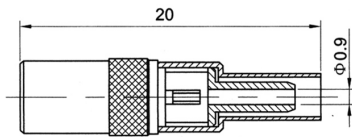

Type	part number	suitable cable	Note
SSMB-K2	1020-6500	2	

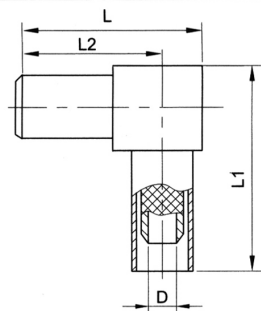

Type	part number	suitable cable	L	L1	L2	Note
SSMB-KW2	1040-6501	2	12.3	14	9.55	$\phi 0.9$
SSMB-KW2-1	1040-6502	2	11.4	13	9.3	$\phi 0.9$
SSMB-KW3	1040-6506	3	12.3	12.9	9.55	$\phi 1.6$
SSMB-KW3-1	1040-6507	3	11.4	13	9.3	$\phi 1.6$

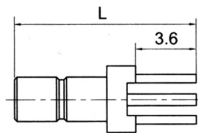
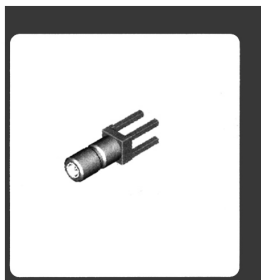

mounting hole

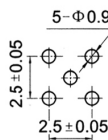

Type	part number	L	Note
SSMB-JHD	1010-5800	10.8	
SSMB-JHD2	1010-5803	13.7	

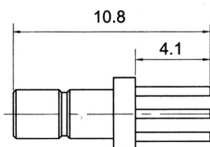

mounting hole

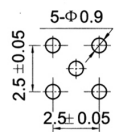

Type	part number	Note
SSMB-JHD1	1010-5802	

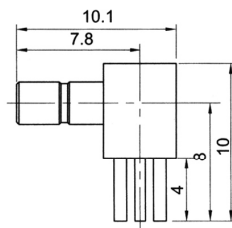
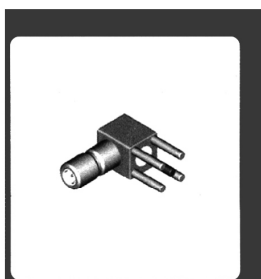

mounting hole

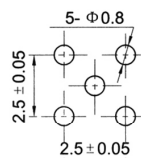

Type	part number	Note
SSMB-JWHD	1030-5800	

SSMB SERIES

CERNEX, Inc.

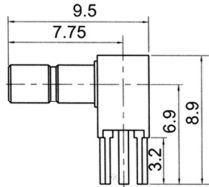
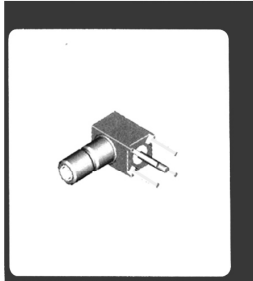

mounting hole

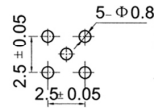

Type	part number	suitable cable	Note
SSMB-JWHD1	1030-5801		

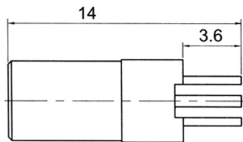

mounting hole

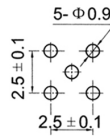

Type	part number	Note
SSMB-KHD	1020-5800	

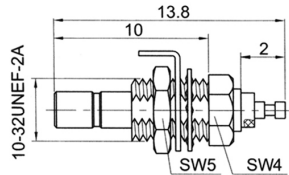

mounting hole

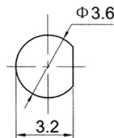

Type	part number	Note
SSMB-JYA	1010-2901	

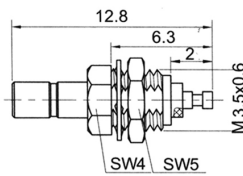

mounting hole

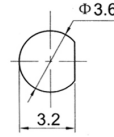

Type	part number	Note
SSMB-JY-1	1010-2902	

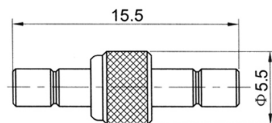

Type	part number	Note
SSMB-JJ	1000-6900	