

**SERIES MCX
RF COAXIAL CONNECTORS**

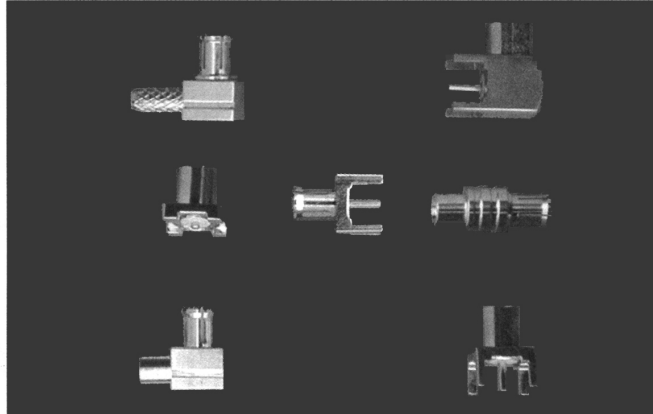

Series MCX is small in size , easy in mating and reliable in contact. MCX series is recommended for use in tight areas where space is limited.

Key performance

- Characteristic Impedance : 50 Ω
- Frequency range : 0~6GHz
- Contact resistance :
 - Center conductor ≤4.0m Ω
 - Out conductor ≤ 2.0m Ω
- Insulation resistance : ≥1000M Ω
- Insulator voltage withstanding : 750V
- VSWR: ≤1.30
- Connector durability : 500 cycles
- Applicable spec/std : IEC1169-36 CECC-22220

Material

- Center contacts:
 - Male---brass, gold plated.
 - Female---beryllium copper, gold plated
- Bodies and other metal parts:
 - brass, gold plated
 - stainless steel ,passivated or gold plated
- Insulators: Teflon
- Crimp ferrule: copper, nickel plated.
- Gasket and seal rings: silicone rubber
- Heat-shrink tubing: thermofit plastic.

Interface Dimensions

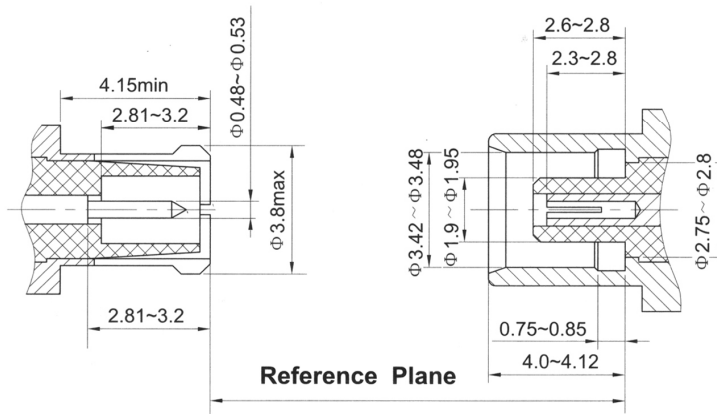

MCX SERIES

CERNEX, Inc.

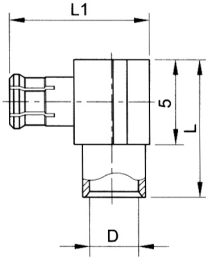

Type	part number	suitable cable	L	L1	D	Note
MCX-JWB1	0030-6601	B1	7	8.4	Φ1.3	
MCX-JWB2	0030-6602	B2	8.4	8.4	Φ2.2	
MCX-JWB3	0030-6603	B3	9.2	9.2	Φ3.6	

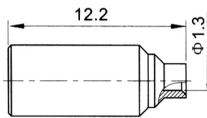
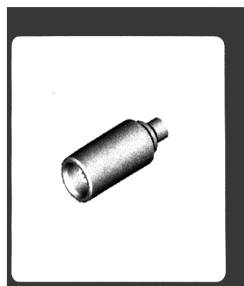

Type	part number	suitable cable	Note
MCX-KB1	0020-6601	B1	

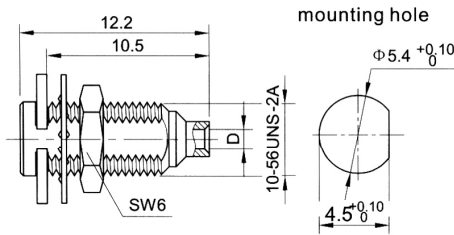
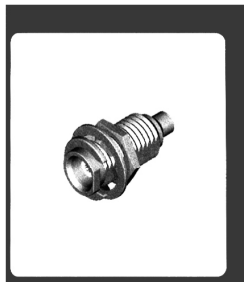

Type	part number	suitable cable	D	Note
MCX-KYB1	0020-2601	B1	Φ1.3	
MCX-KYB2	0020-2602	B2	Φ2.2	

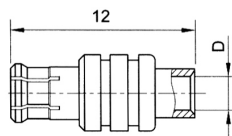

Type	part number	suitable cable	D	Note
MCX-JB2	0010-6601	B2	Φ2.2	
MCX-JB3	0010-6602	B3	Φ3.6	

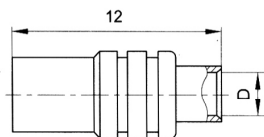

Type	part number	suitable cable	D	Note
MCX-KB2	0020-6602	B2	Φ2.2	
MCX-KB3	0020-6603	B3	Φ3.6	

MCX SERIES

CERNEX, Inc.

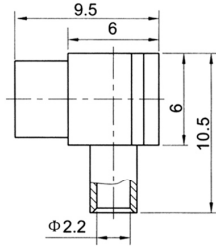

Type	part number	suitable cable	Note
------	-------------	----------------	------

MCX-KWB2	0040-6601	B2	
----------	-----------	----	--

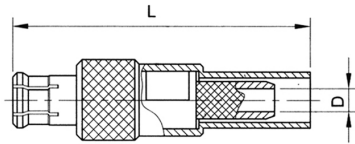

Type	part number	suitable cable	L	D	Note
------	-------------	----------------	---	---	------

MCX-J2	0010-6501	2	19.5	$\Phi 0.9$	
MCX-J3	0010-6502	3	20.5	$\Phi 1.6$	
MCX-J4YA	0010-6504	4	20.5	$\Phi 2.2$	

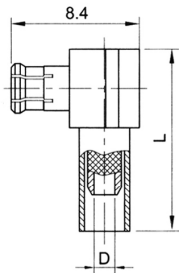

Type	part number	suitable cable	L	D	Note
------	-------------	----------------	---	---	------

MCX-JW2	0030-6501	2	11.1	$\Phi 0.9$	
MCX-JW3	0030-6502	3	11.7	$\Phi 1.6$	
MCX-JW3A	0030-6503	3A	12.6	$\Phi 1.6$	

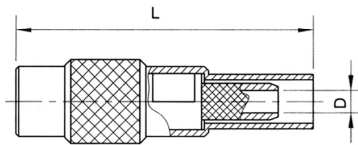

Type	part number	suitable cable	L	D	Note
------	-------------	----------------	---	---	------

MCX-K2	0020-6501	2	21.8	$\Phi 0.9$	
MCX-K3	0020-6502	3	23.3	$\Phi 1.6$	

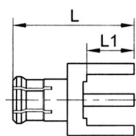
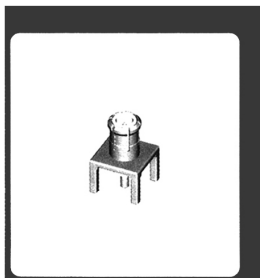

mounting hole

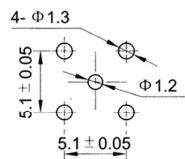

Type	part number	L	L1	Note
------	-------------	---	----	------

MCX-JHD	0010-5801	9.7	3.9	
MCX-JHD1	0010-5802	8.7	2.9	
MCX-JHD2	0010-5803	7.5	1.7	

MCX SERIES

CERNEX, Inc.

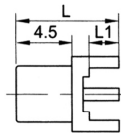
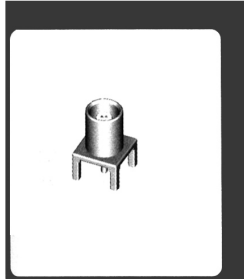

mounting hole

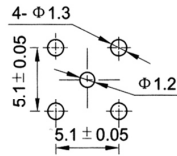

Type	part number	L	L1	Note
MCX-KHD	0020-5801	8.3	2.9	
MCX-KHD1	0020-5802	9.3	3.9	
MCX-KHD2	0020-5803	7.1	1.7	
MCX-KHD3	0020-5804	11.3	3.9	
MCX-KHD4	0020-5805	10.1	3.5	
MCX-KHD7	0020-5808	8.6	2.6	
MCX-KHD10	0020-58011	12.5	2.7	

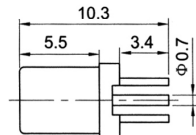
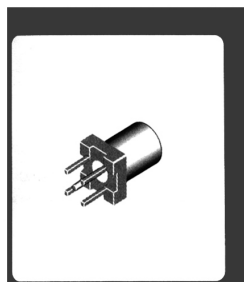

mounting hole

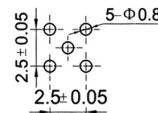

Type	part number	Note
MCX-KHD9	0020-5810	

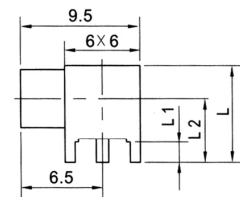
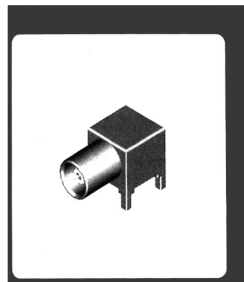

mounting hole

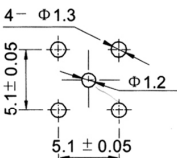

Type	part number	L	L1	L2	Note
MCX-KWHD	0040-5801	7.7	1.7	4.7	
MCX-KWHD1	0040-5802	8.9	3.9	5.9	
MCX-KWHD2	0040-5803	9.9	2.9	6.9	

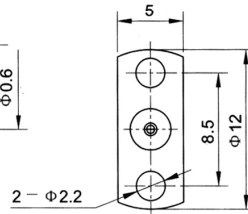
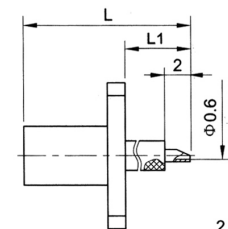
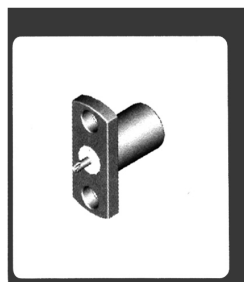

Type	part number	L	L1	Note
MCX-KF	0020-1901	10	2	
MCX-KF1	0020-1902	16	8	

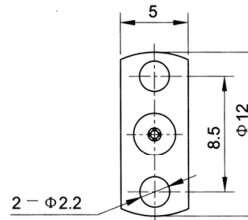
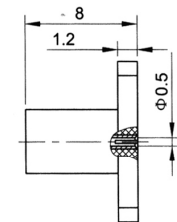
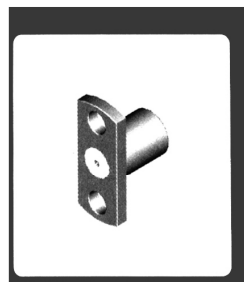

Type	part number	Note
MCX-KF2	0020-1903	suitable pin 0.5 ± 0.02

MCX SERIES

CERNEX, Inc.

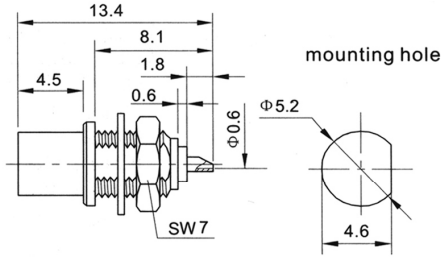

Type part number	Note
MCX-KY 0020-2901	

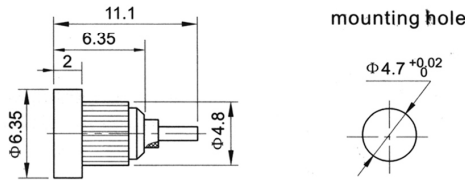

Type part number	Note
MCX-KPD 0020-3801	

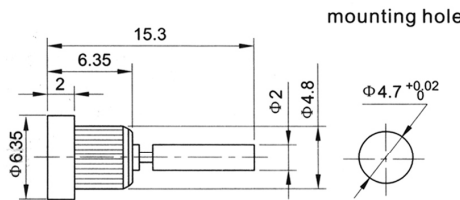

Type part number	Note
MCX-KPD1 0020-3802	

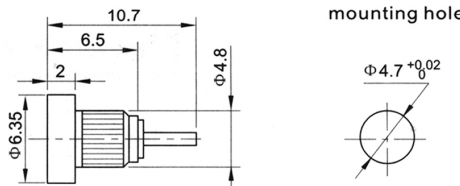

Type part number	Note
MCX-KPD2 0020-3803	

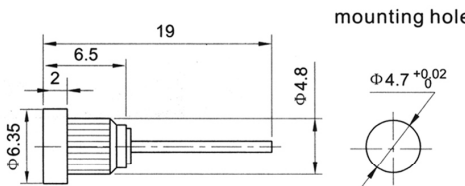
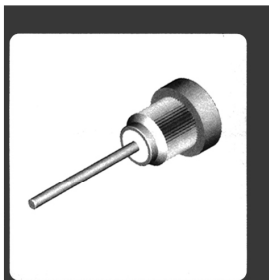

Type part number	Note
MCX-KPD3 0020-3804	SUCO plated