

**SERIES L9-75
RF COAXIAL CONNECTORS**

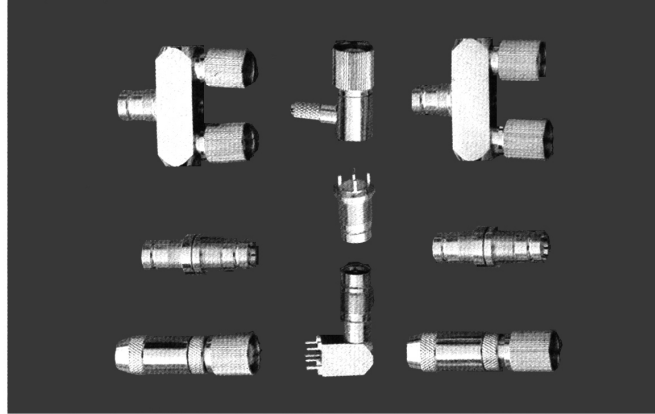

Key performance

Characteristic Impedance : 75 Ω
 Frequency range : 0~1GHz
 Contact resistance :
 Center conductor ≤ 10.0m Ω
 Out conductor ≤ 4.0m Ω
 Insulation resistance : ≥ 1000M Ω
 Insulator voltage withstanding : 1000V
 VSWR : ≤ 1.30
 Connector durability : 500 cycles
Applicable spec/std : IEC169-13

Material

Center contacts:
 Male---brass, gold plated.
 Female---phosphor bronze, gold plated
 Bodies and other metal parts:
 brass, gold or nickel plated
 Insulators: Teflon
 Crimp ferrule: copper, nickel plated.
 Gasket and seal rings: silicone rubber
 Heat-shrink tubing: thermofit plastic.

Interface Dimensions

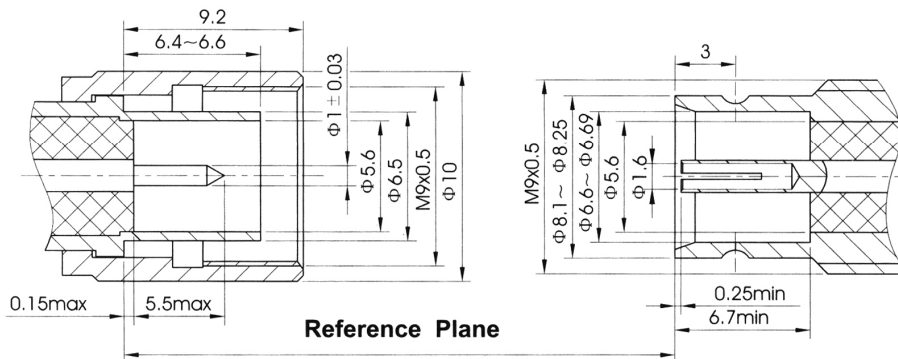

L9-75 SERIES

CERNEX, Inc.

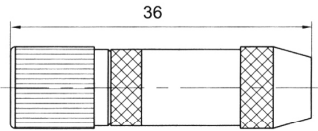

Type	part number	suitable cable	Note
L9-75J3	5611-6502	3	
L9-75J12YC	5611-6510	12	

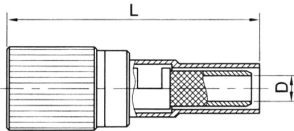

Type	part number	suitable cable	L	D	Note
L9-75J3Y	5611-6503	3	25.6	Φ1.6	
L9-75J12Y	5611-6508	12	31	Φ3.1	

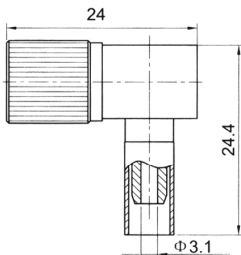
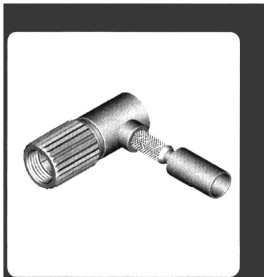

Type	part number	suitable cable	Note
L9-75JW12Y	5631-6501	12	



Mounting hole

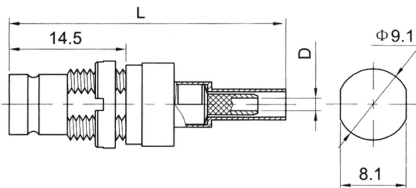

Type	part number	suitable cable	L	D	Note
L9-75KY3Y	5621-2501	3	27.5	Φ1.6	
L9-75KY4Y	5621-2502	4	37	Φ2.2	

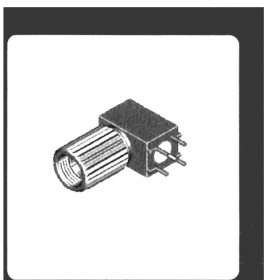

Mounting hole

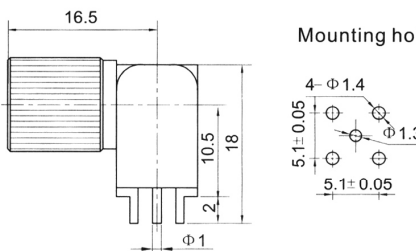

Type	part number	Note
L9-75JWHD	5631-5801	

L9-75 SERIES

CERNEX, Inc.

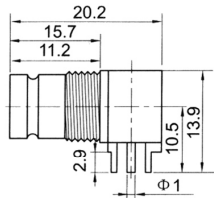
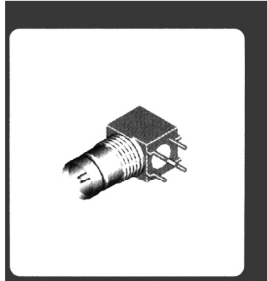

Mounting hole

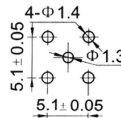

Type part number

Note

L9-75KWHD 5641-5801

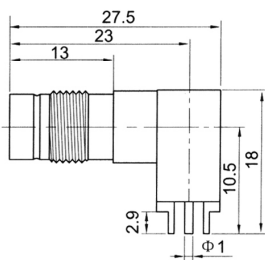
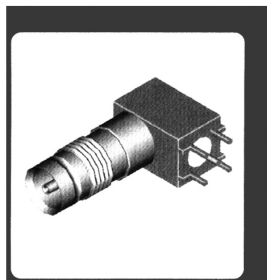

Mounting hole

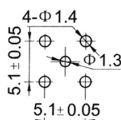

Type part number

Note

L9-75KWHD1 5642-5802

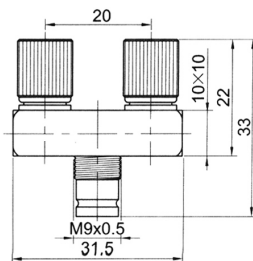
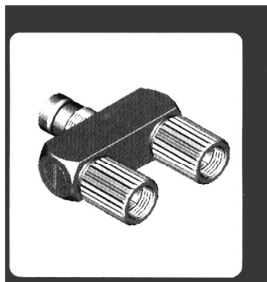

Type part number

Note

L9-75JKJW 5601-6901

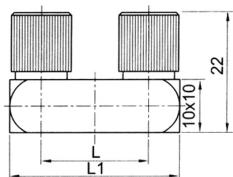
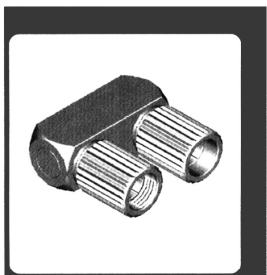

Type part number

L

L1

Note

L9-75JJWW 5601-6902

15

26.5

L9-75JJWWA 5601-6903

20

31.5