

SERIES J.CC11 (CCWX) RF COAXIAL CONNECTORS

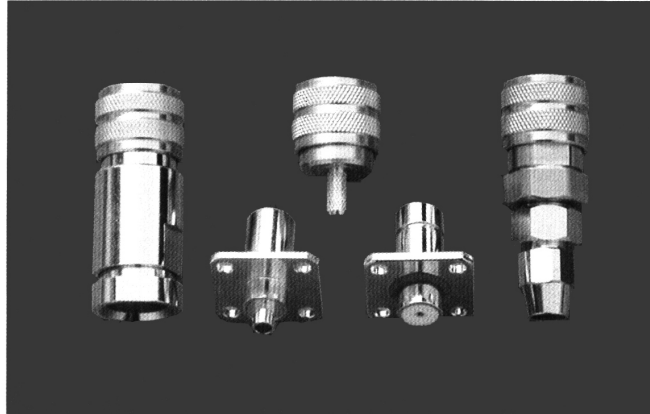

Series J.CC11 is a push-pull self-latching style middle-power RF coaxial connector. The advantages are high vibration-proof, reliable connection, excellent mechanical and electrical performance. It is mainly used in military weapon systems. CCWX is improved from CC11, can cross-over with CC11, has ability of interface self-adopting, the phase of connection is much more stability and the electrical performance is also improved.

Key performance

Characteristic Impedance : 50 Ω
 Frequency range : 0~6GHz
 Contact resistance :
 Center conductor ≤ 1.5m Ω
 Out conductor ≤ 0.2m Ω
 Insulator voltage withstanding : 1500V
 VSWR :
 straight ≤ 1.30
 right angle ≤ 1.40
 Connector durability : 500 cycles

Applicable spec/std : J.Q/FD2002-09

Material

Center contacts:
 Male---brass, gold plated.
 Female---phosphor bronze, gold plated
 Bodies and other metal parts:
 brass, nickel plated
 Insulators: Teflon
 Crimp ferrule: copper, nickel plated.
 Gasket and seal rings: silicone rubber
 Heat-shrink tubing: thermofit plastic

Interface Dimensions

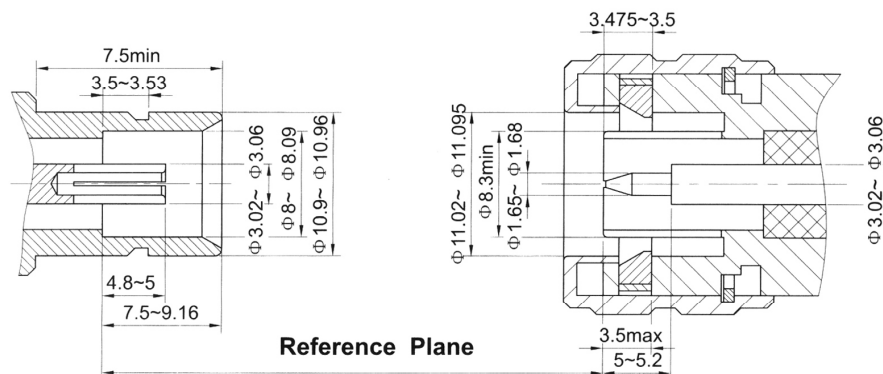

J.CC11(CCWX) SERIES

CERNEX, Inc.

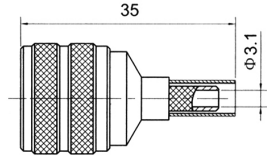

| Type | part number | suitable cable | Note |
|--------------|-------------|----------------|-------------------------------|
| J.CC11-J5YAG | 1714-6501 | 5A | coupling nut, stainless steel |

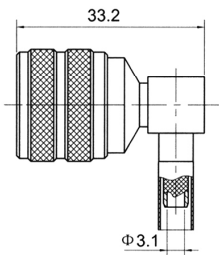

| Type | part number | suitable cable | Note |
|---------------|-------------|----------------|-------------------------------|
| J.CC11-JW5YAG | 1731-6500 | 5A | coupling nut, stainless steel |

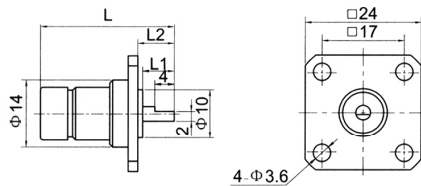

| Type | part number | L | L1 | L2 | Note |
|--------------|-------------|------|-----|-----|------|
| J.CC11-KFD-1 | 1721-0001 | 27.5 | 6.5 | 7.5 | |
| J.CC11-KFD-2 | 1721-0002 | 28.5 | 7.5 | 8.5 | |

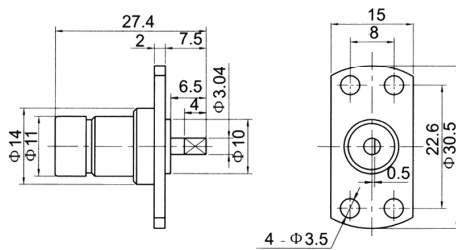
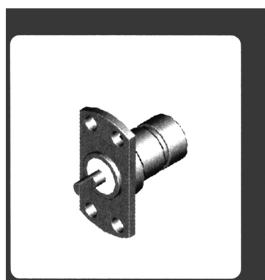

| Type | part number | Note |
|--------------|-------------|------|
| J.CC11-KFD-3 | 1721-0003 | |

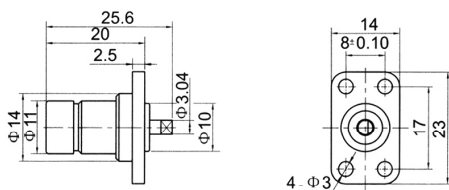
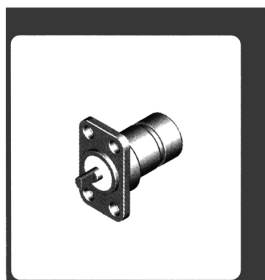

| Type | part number | Note |
|--------------|-------------|------|
| J.CC11-KFD12 | 1721-0004 | |

J.CC11(CCWX) SERIES

CERNEX, Inc.

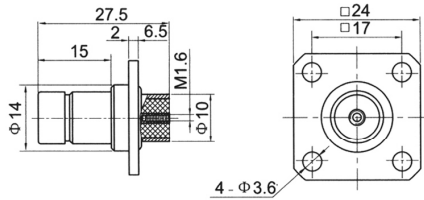
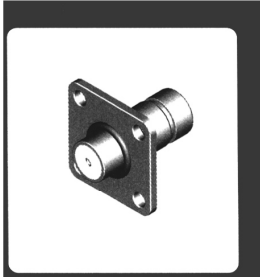

| Type | part number | suitable cable | Note |
|-------------|-------------|----------------|------|
| J.CC11-KFD3 | 1721-0005 | | |

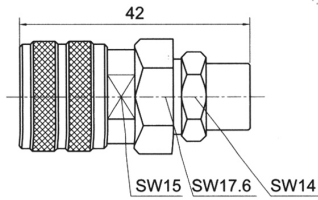

| Type | part number | suitable cable | Note |
|--------------------|-------------|----------------|-------------------------------|
| J.CC11(CCWX)-J501G | 26141-6701 | 501 | coupling nut, stainless steel |

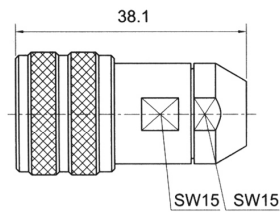

| Type | part number | suitable cable | Note |
|--------------|-------------|----------------|-------------------------------|
| J.CCWX-J610G | 26141-6501 | 610 | coupling nut, stainless steel |